

Gripper Chain

For form, fill, and vacuum seal
wrapping applications

The complete package

- Reliable performance
- Longer wear life
- Competitive price
- Quick delivery
- Lube free version available



Tsubaki Gripper Chain

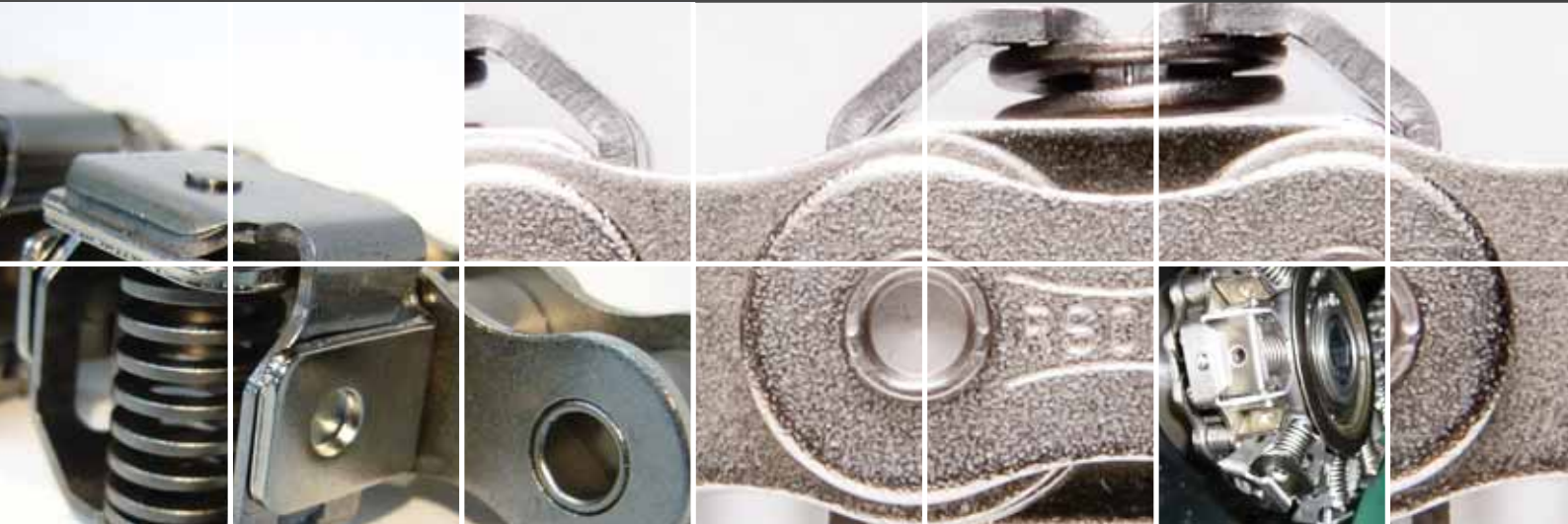

A formidable new force has taken hold of wrapping operations: Gripper Chain from Tsubaki.

Our high-performance roller chain is now available with innovative new side-swivel gripper attachments for form, fill, and vacuum seal applications.

Get a grip on truly profitable performance

Discover the difference Tsubaki's high-quality base chain makes to your bottom line.

- Lower maintenance costs
- Increased operating time
- Increased productivity

RS08BNPKU Type M

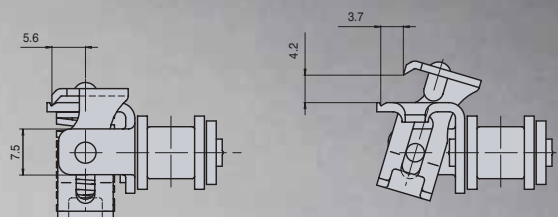
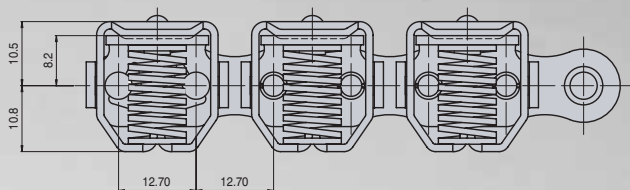

RS10BNPKU Type M

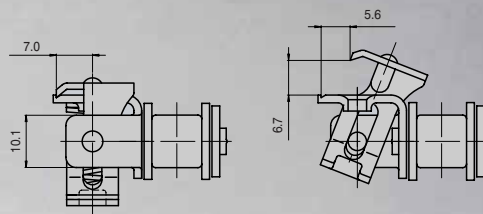
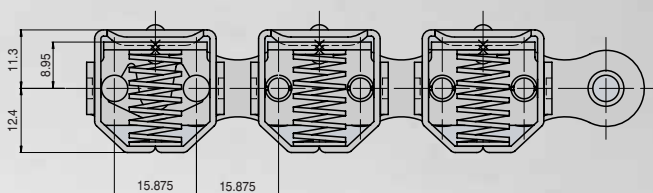

ISO Ref.	Chain No.	Connecting Link	Pitch	Roller Dia.	Inside Width	Clamping Force	Materials		
							Base Chain	Clamp	Spring
08B-1	RS08BNPKU Type M	RS08BNPKU CL Type M	12.70	8.51	7.75	50	NP	304SS	SA
10B-1	RS10BNPKU Type M	RS10BNPKU CL Type M	15.875	10.16	9.65	70	NP	304SS	SA

NP = Nickel-Plated Steel SS = Stainless Steel SA = Special Alloy

Notes: Do not twist chain. Use care not to damage attachment when unwinding chain from reel.

Tsubakimoto Europe BV

Belder 1
4704 RK, Roosendaal
The Netherlands

Phone: +31 (0)165 59 48 00
Facsimile: +31 (0)165 54 94 50
E-mail: info@tsubaki.nl
Internet: <http://tsubaki.nl>

Tsubakimoto Europe BV

Waalhaven Z/Z 42
3088 HJ, Rotterdam
The Netherlands

Phone: +31 (0)10 494 18 18
Facsimile: +31 (0)10 429 49 06
E-mail: office@tsubaki.nl
Internet: <http://tsubaki.nl>

Tsubakimoto UK Ltd.

Osier Drive, Sherwood Park
Annesley, Nottingham NG15 0DX
United Kingdom

Phone: +44 (0)1623 68 87 88
Facsimile: +44 (0)1623 68 87 89
E-mail: sales@tsubaki.co.uk
Internet: <http://www.tsubaki.co.uk>